

John Bolley

ARIZONA DEPARTMENT OF LIQUOR LICENSES & CONTROL

800 W Washington 5th Floor
Phoenix AZ 85007-2934
(602) 542-5141

400 W Congress #521
Tucson AZ 85701-1352
(520) 628-6595

2/4/14 OK 020397
make out to ADOR - OK 020398

25.00 each

APPLICATION FOR SPECIAL EVENT LICENSE

Fee = \$25.00 per day for 1-10 day events only
A service fee of \$25.00 will be charged for all dishonored checks (A.R.S. § 44-6852)

NOTE: THIS DOCUMENT MUST BE FULLY COMPLETED OR IT WILL BE RETURNED.
PLEASE ALLOW 10 BUSINESS DAYS FOR PROCESSING.

**Application must be approved by local government before submission to Department of Liquor Licenses and Control. (Section #20)

DLIC USE ONLY
LICENSE #

1. Name of Organization: ST THOMAS MORE PARISH

2. Non-Profit/I.R.S. Tax Exempt Number

3. The organization is a: (check one box only)

- Charitable
- Fraternal (must have regular membership and in existence for over 5 years)
- Civic
- Political Party, Ballot Measure, or Campaign Committee
- Religious

4. What is the purpose of this event? PARISH APPEALATION PICNIC

5. Location of the event: 6180 WEST UTOPIA ROAD GLENDALE MARICOPA 85308
Address of physical location (Not P.O. Box) City County Zip

Applicant must be a member of the qualifying organization and authorized by an Officer, Director or Chairperson of the Organization named in Question #1. (Signature required in section #18)

6. Applicant: TURNER JAMES F. [Redacted]
Last First Middle Date of Birth

7. Applicant's Mailing Address: 6180 WEST UTOPIA ROAD GLENDALE AZ 85308
Street City State Zip

8. Phone Numbers: (623) 566-8222 (623) 566-8222 [Redacted]
Site Owner # Applicant's Business # Applicant's Home #

9. Date(s) & Hours of Event: (Remember: you cannot sell alcohol before 10:00 a.m. on Sunday)

	Date	Day of Week	Hours from A.M./P.M.	To A.M./P.M.
Day 1:	MAY 3 2015	SUNDAY	3pm	4pm
Day 2:				
Day 3:				
Day 4:				
Day 5:				
Day 6:				
Day 7:				
Day 8:				
Day 9:				
Day 10:				

10. Has the applicant been convicted of a felony in the past five years, or had a liquor license revoked?
 YES NO (attach explanation if yes)

11. This organization has been issued a special event license for 0 days this year, including this event
(not to exceed 10 days per year).

12. Is the organization using the services of a promoter or other person to manage the event? YES NO
If yes, attach a copy of the agreement.

13. List all people and organizations who will receive the proceeds. Account for 100% of the proceeds.
THE ORGANIZATION APPLYING MUST RECEIVE 25% OF THE GROSS REVENUES OF THE SPECIAL EVENT.

Name ST THOMAS MORE PARISH 100%
Address 6180 WEST UTOPIA ROAD GLENDALE 85308 Percentage

Name _____ Percentage
Address _____

(Attach additional sheet if necessary)

14. Knowledge of Arizona State Liquor Laws Title 4 is important to prevent liquor law violations. If you have any questions regarding the law or this application, please contact the Arizona State Department of Liquor Licenses and Control for assistance.

NOTE: ALL ALCOHOLIC BEVERAGE SALES MUST BE FOR CONSUMPTION AT THE EVENT SITE ONLY.
"NO ALCOHOLIC BEVERAGES SHALL LEAVE SPECIAL EVENT PREMISES."

15. What security and control measures will you take to prevent violations of state liquor laws at this event?
(List type and number of security/police personnel and type of fencing or control barriers if applicable)

2 # Police Fencing
 # Security personnel Barriers

16. Is there an existing liquor license at the location where the special event is being held? YES NO
If yes, does the existing business agree to suspend their liquor license during the time period, and in the area in which the special event license will be in use? YES NO

(ATTACH COPY OF AGREEMENT)

ST. THOMAS MORE CATHOLIC CHURCH (603) 566-8222
Name of Business Phone Number

17. Your licensed premises is that area in which you are authorized to sell, dispense, or serve spirituous liquors under the provisions of your license. The following page is to be used to prepare a diagram of your special event licensed premises. Please show dimensions, serving areas, fencing, barricades or other control measures and security positions.

THIS SECTION TO BE COMPLETED ONLY BY AN OFFICER, DIRECTOR OR CHAIRPERSON OF THE ORGANIZATION NAMED IN QUESTION #1

18. I, JAMES TURNER declare that I am an Officer/Director/Chairperson appointing the applicant listed in Question 6, to apply on behalf of the foregoing organization for a Special Event Liquor License.

X [Signature] (Signature) PASTOR (Title/Position) 1-28-15 (Date) (623) 5668222 (Phone #)

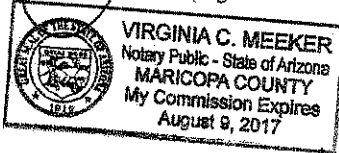

State of

ARIZONA County of MARICOPA

The foregoing instrument was acknowledged before me this

28th JANUARY 2015

My Commission expires on: AUG 9 2017 (Date)

[Signature] (Signature of NOTARY PUBLIC)

THIS SECTION TO BE COMPLETED ONLY BY THE APPLICANT NAMED IN QUESTION #6

19. I, JAMES TURNER declare that I am the APPLICANT filing this application as listed in Question 6. I have read the application and the contents and all statements are true, correct and complete.

X [Signature] (Signature) State of ARIZONA County of MARICOPA

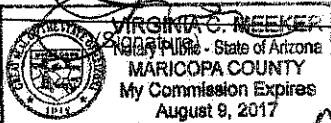

The foregoing instrument was acknowledged before me this

28th JANUARY 2015

My commission expires on: AUG 9 2017 (Date)

[Signature] (Signature of NOTARY PUBLIC)

You must obtain local government approval. City or County MUST recommend event and complete item #20. The local governing body may require additional applications to be completed and submitted 60 days in advance of the event. Additional licensing fees may also be required before approval may be granted.

LOCAL GOVERNING BODY APPROVAL SECTION

20. I, _____ (Government Official) _____ (Title) hereby recommend this special event application on behalf of _____ (City, Town or County) _____ (Signature of OFFICIAL) _____ (Date)

FOR DLLC DEPARTMENT USE ONLY

Department Comment Section:

(Employee) _____ (Date)

APPROVED DISAPPROVED BY: _____

(Title) _____ (Date)

SPECIAL EVENT LICENSED PREMISES DIAGRAM
(This diagram must be completed with this application)

Special Event Diagram: (Show dimensions, serving areas, and label type of enclosure and security positions)
NOTE: Show nearest cross streets, highway, or road if location doesn't have an address.

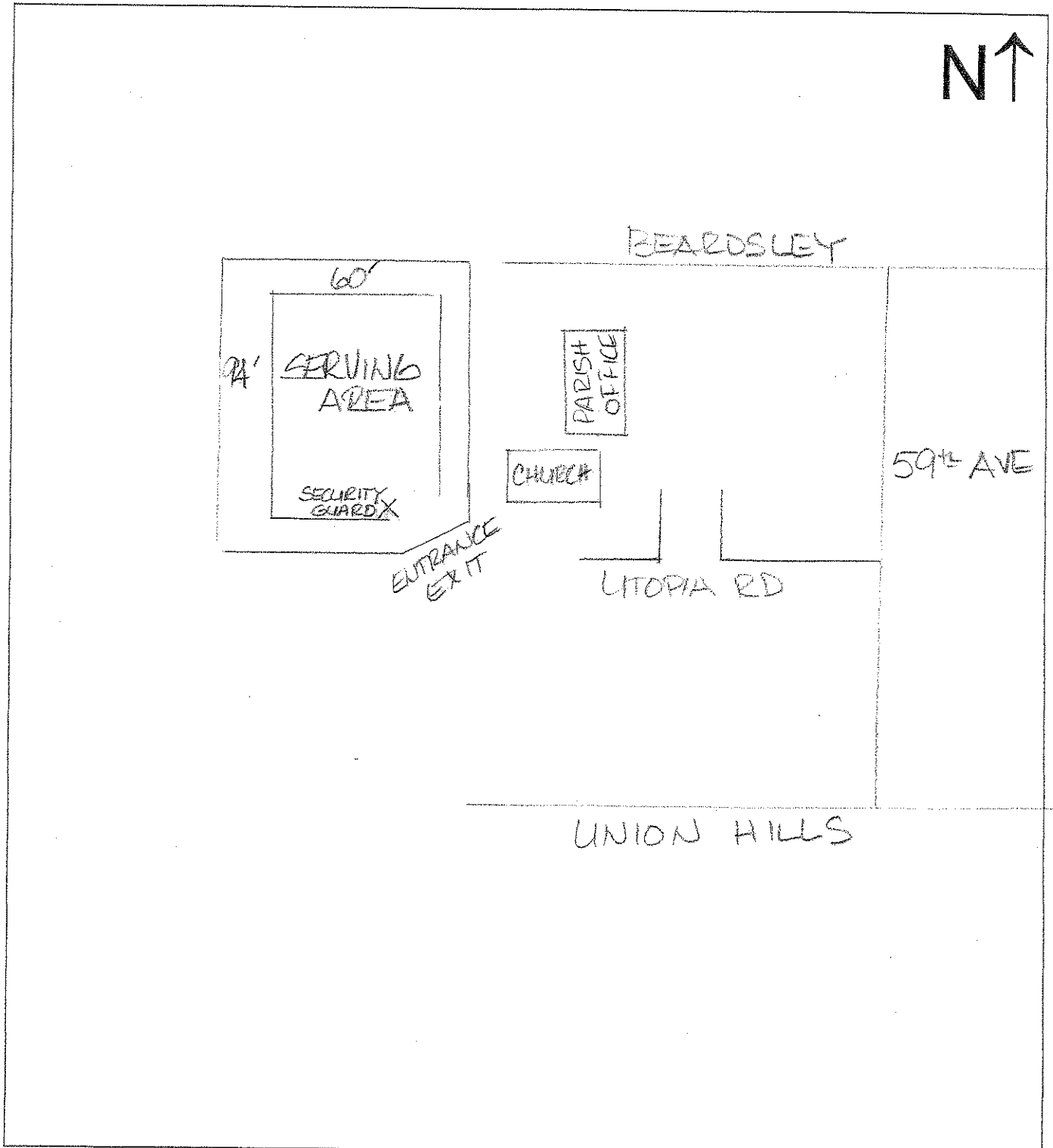

SPECIAL EVENT LICENSED PREMISES DIAGRAM
(This diagram must be completed with this application)

Special Event Diagram: (Show dimensions, serving areas, and label type of enclosure and security positions)
NOTE: Show nearest cross streets, highway, or road if location doesn't have an address.

